

VANCOUVER ISLAND Outdoor SHOW



New LOCATION for 2026
COWICHAN EXHIBITION PARK
7380 Trans Canada Hwy, Duncan BC

April 10, 11, 12, 2026

Vancouver Island's Premiere Outdoor Recreation Event! FEATURING: Bikes, Boats, RV's, Lodges, Fishing, Off-roading, Adventure Sports, Hunting, Camping & MORE!

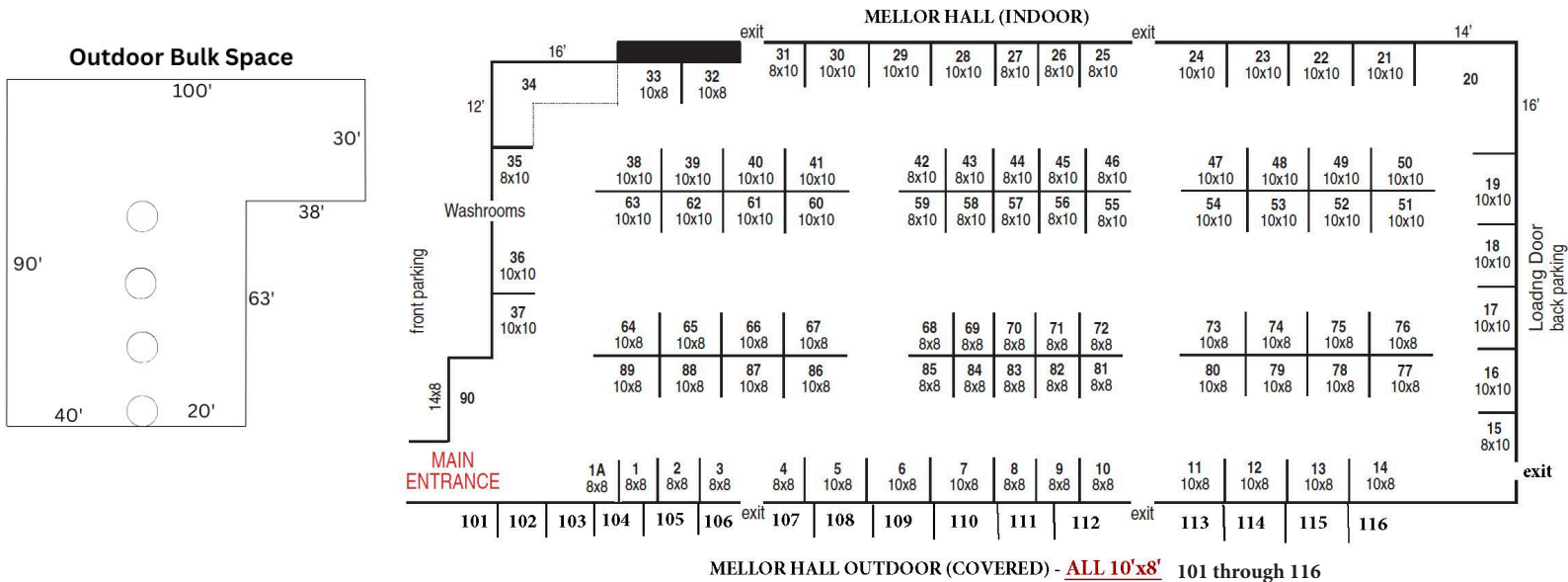

Booth Cost

Outdoor Bulk Space	\$1.50 SqFt
Indoor Bulk Space	\$2.25 SqFt
Outdoor 10x8	\$400.00 plus GST
Single: 8'x8'	\$550.00 plus GST
Single: 10'x8'	\$625.00 plus GST
Single: 10'x10'	\$725.00 plus GST
Corners	add \$125.00 plus GST
Deposit	\$250.00 per booth upon booking

Set-Up Times

Thursday, April 09	12:00pm to 8:00pm
Friday, April 10	8:00am to 12:00pm
Bulk Spaces	To be arranged

Move Out

Sunday, April 12	4:00pm to 10pm
------------------	----------------

Indoor Bulk Space Barn

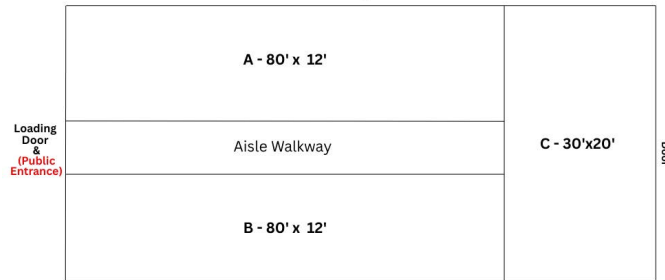

Show Hours / Dates

Friday,	April 10	1:00 pm to 8:00 pm
Saturday,	April 11	10:00 am to 6:00 pm
Sunday,	April 12	10:00 am to 4:00 pm

Show Management

Evergreen Exhibitions Ltd - Parksville, BC

Contact: Marc Gervais

marchomeshowtime@shaw.ca

Phone: 250-248-4440 / 800-471-1112

SHOW CONDITIONS: See next pages

Visit us at: www.VIOUTDOORSHOW.com

Promotional Opportunities

Each exhibitor booking is automatically included in the list of exhibitors printed in the show guide and listed on the show web page. There are additional opportunities available for exhibitors to promote themselves before and during the show.

They are optional and not included with booth rental. Promotional options are available on a first-come, first-served basis.

<p>Featured Exhibitor – Limited Availability! <i>Make your booth listing stand out</i></p> <ul style="list-style-type: none"> Bolded company name, phone number, and website printed in colour, with booth number in colour on show map 	<p>\$50.00</p>
<p>Premiere Exhibitor – Only 3 Spots Available! <i>Highlight your brand leading up to the show</i></p> <ul style="list-style-type: none"> Full colour logo included on all full page ads for specific show, and logo linked to your website on Event page at www.vioutdoorshow.com, as well as Featured Exhibitor benefits 	<p>\$300.00</p>
<p>*NEW* Deluxe Exhibitor – Only 3 Spots Available! <i>Showcase your brand leading up to the show</i></p> <ul style="list-style-type: none"> Digital Display ad (500x200px) linked to your website on Event page at www.vioutdoorshow.com, as well as Featured/Premiere Exhibitor benefits above <p>Digital Display ads available separately as well -</p>	<p>\$500.00</p> <p>Inquire for details</p>
<p>Door Prize Sponsor – Limited Availability! <i>Supply Door Prize to show attendees</i></p> <ul style="list-style-type: none"> Sponsors receive extra promotion on show webpage, advertising and on site at the event. Conditions apply, please inquire for details 	<p>Prize must be \$250+ in value</p>

Promotional fees are subject to 5% GST

Limited Availability – Act Now! To secure your enhanced listing, please contact adminhomeshowtime@shaw.ca or 1-800-471-1112 today.

Rental Request

Booth Carpet and tables ***are optional and not included with a booth reservation.*** Rental items are available on a first-come, first-served basis. Rental requests received **after April 3, 2026** will be considered a **late order**.

Note: may not be available on site at the show!

RENTAL ITEMS	Pre-Show Discount	Late Order (After April 3)	Quantity	Amount
6' Table non-skirted	\$30.00	\$40.00		
8' Table non-skirted	\$30.00	\$40.00		
6' Table skirted (top with skirt three sides)	\$45.00	\$55.00		
8' Table skirted (top with skirt three sides)	\$45.00	\$55.00		
Booth Carpeting - Black	\$0.50 sq ft	\$0.60 sq ft		
TOTAL DUE (PST & GST will be added to invoice)				

Please complete the following before submitting:

Show: Vancouver Island Outdoor Show - April 10-12, 2026

Company Name:

Contact:

Phone:

Credit Card:

Expiry Date:

CVV:

Name on Card:

Rental fees are subject to 5% GST and 7% PST and will be added to your invoice!

Email completed form to adminhomeshowtime@shaw.ca

☐ Etransfer after receiving invoice

☐ Charge to my CC

2026 Vancouver Island Outdoor Show



EXHIBITOR INFORMATION & CONDITIONS

SHOW LOCATION ► **Cowichan Exhibition Park - 7380 Trans Canada Hwy, Duncan, BC**

SHOW DATES AND HOURS
(PUBLIC) ►

Friday,	April 10	1:00 pm	to	8:00 pm
Saturday,	April 11	10:00 am	to	6:00 pm
Sunday,	April 12	10:00 am	to	4:00 pm

Doors open for exhibitors **1-hour** prior to show Saturday and Sunday.

MOVE IN ►

Thursday,	April 09	12:00 pm	to	8:00 pm
Friday,	April 10	8:00 am	to	12 Noon

BULK/FEATURE BOOTHS - TO BE ARRANGED

No dollies or trollies on Friday. Carry-in only!

NO TAPING TO VENUE FLOORS UNLESS APPROVED BY SHOW MANAGEMENT FIRST!

MOVE IN ►

Sunday,	April 12	4:00pm	to	10:00pm
Monday,	April 13	TBD		

No exhibitors may commence to dismantle, pack, or remove any part of their exhibit prior to 4:00 pm on closing day.

Exhibit space must be paid in full by show date. Show Management reserves the right to refuse entry to any exhibitor whose account has not been **PAID IN FULL**.

PAYMENT OF ACCOUNTS ►

DEPOSIT - \$250 per booth due at time of booking

FINAL PAYMENT - Due 31 days prior to show date (March 10, 2026)

PAYMENT METHODS - Cheque, E-Transfer (adminhomeshowtime@shaw.ca), VISA, MASTERCARD, AMEX by phone or ONLINE @ www.homeshowtime.com/exhibitors/make-payment/

AGREEMENT - By making payment you are agreeing to the terms and conditions set out in this document

- CANCELLATION/REFUND POLICY ►** Booth cancellation **more than 61 days** prior to show are eligible for a refund of 50% of monies paid.
- Cancellations **61 days or less** to show dates are **NOT** eligible for a refund of any monies paid.
- Show Management reserves the right to cancel bookings and retain monies previously received for any account not paid in full one week after final payment due date for the event.
- SHOW CANCELLATION/ POSTPONEMENT ►** Show Management reserves the right at all times to change the dates/location or cancel/postpone the show outright in cases or circumstances beyond the control of Evergreen Exhibitions Ltd.
- In the event of show cancellation, exhibitors will be refunded monies paid **less** any unrecoverable expenses already paid by show management to suppliers, facilities and contractors.
- PARKING ►** Exhibitor parking is free in **designated areas only!**
- SMOKING ►** **NO SMOKING is permitted on the premises, inside or outside in the surrounding area except in designated smoking zones**
- FIRE REGULATIONS ►** All decorative materials must meet with flame-proofing and other requirements of the Fire Marshall.
- BOOTH LOCATIONS ►** Show Management reserves the right to move exhibitors for the overall benefit of the show.
- INSURANCE ►** We have \$5,000,000.00 liability insurance and provide security; however, Show Management will not assume any responsibility for the safety of exhibits against theft, robbery, fire, accidents or other mishaps. In all cases, exhibitors must insure their goods, both personal and exhibits, against any such loss.
- ALTERING OF EXHIBITS ►** Show management reserves the right at any time, without prior notification to alter exhibits, aisles, common carpets, feature size, locations or those exhibits which encroach on other exhibits or common areas and/or pose a safety hazard to the public or other exhibitors. **Show Management's decision in this regard is final**
- STAFFING OF EXHIBITS ►** It is expected that all booths will have staffing at all times during show hours.
- SIGNS ►** Must be professionally made. No signs may be higher than your drapes without Show Management approval.
- PRODUCTS EXHIBITED ►** Products/Services exhibit ed are restricted to those identified and approved by show management in advance.
- SUBLETTING ►** No exhibitor may sublet any portion of their booth space to another supplier without the express consent of the Show Management.

ELECTRICAL & DISPLAY SERVICES ► See Evergreen Exhibitions Rental Request Form. Exhibitors are responsible for special requests.

ALL BOOTHS SUPPLIED WITH WI-FI AND THE FOLLOWING;

- | | |
|---|---|
| SINGLE BOOTHS ► | <ul style="list-style-type: none">• 8ft high drapery back wall (registered flame retardant)• 3ft high drapery side walls (registered flame retardant)• One 750 watt single power outlet (CSA approved, installed by Licensed Electrician under permit) |
| DOUBLE BOOTHS ► | <ul style="list-style-type: none">• 8ft high drapery back wall (registered flame retardant)• 3ft high drapery side walls (registered flame retardant)• One 1200 watt double power outlet (CSA approved, installed by Licensed Electrician under permit) |
| TRIPLE BOOTHS ► | <ul style="list-style-type: none">• 8ft high drapery back wall (registered flame retardant)• 3ft high drapery side walls (registered flame retardant)• One 1200 watt double power outlet (CSA approved, installed by Licensed Electrician under permit) |
| BULK BOOTHS ►
(<u>FOUR BOOTHS OR MORE</u>) | <ul style="list-style-type: none">• 8ft high drapery back wall (registered flame retardant)• One 1200 watt double power outlet (CSA approved, installed by Licensed Electrician under permit) |

*** No Popcorn Machines or Helium Balloons without show management approval ***

NOTE

Show Management is not responsible for losses due to labour disputes or criminal activities

All of us at Evergreen Exhibitions look forward to working with you to make this years *Vancouver Island Outdoor Show* a huge success!

Sincerely,

Darcy Hope
President

www.VIOUTDOORSHOW.com